

# HOW TO MEASURE YOUR OPENING

PG 1

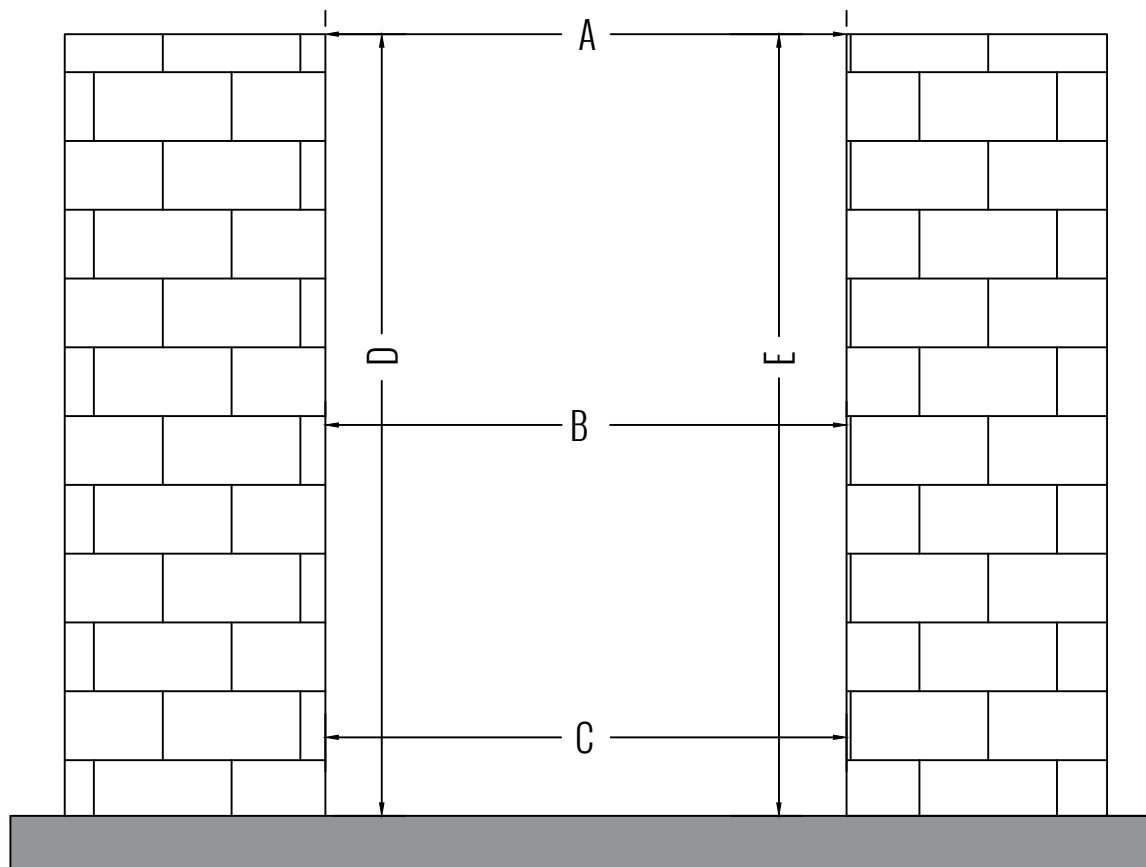

MEASUREMENTS FROM OUTSIDE LOOKING IN

# POST INSTALLATION

PG 2

RECOMMENDED  
ANCHOR  
3/8"X3  
- SLEEVE ON BRICK  
AND BLOCK  
- WEDGE ON  
CONCRETE

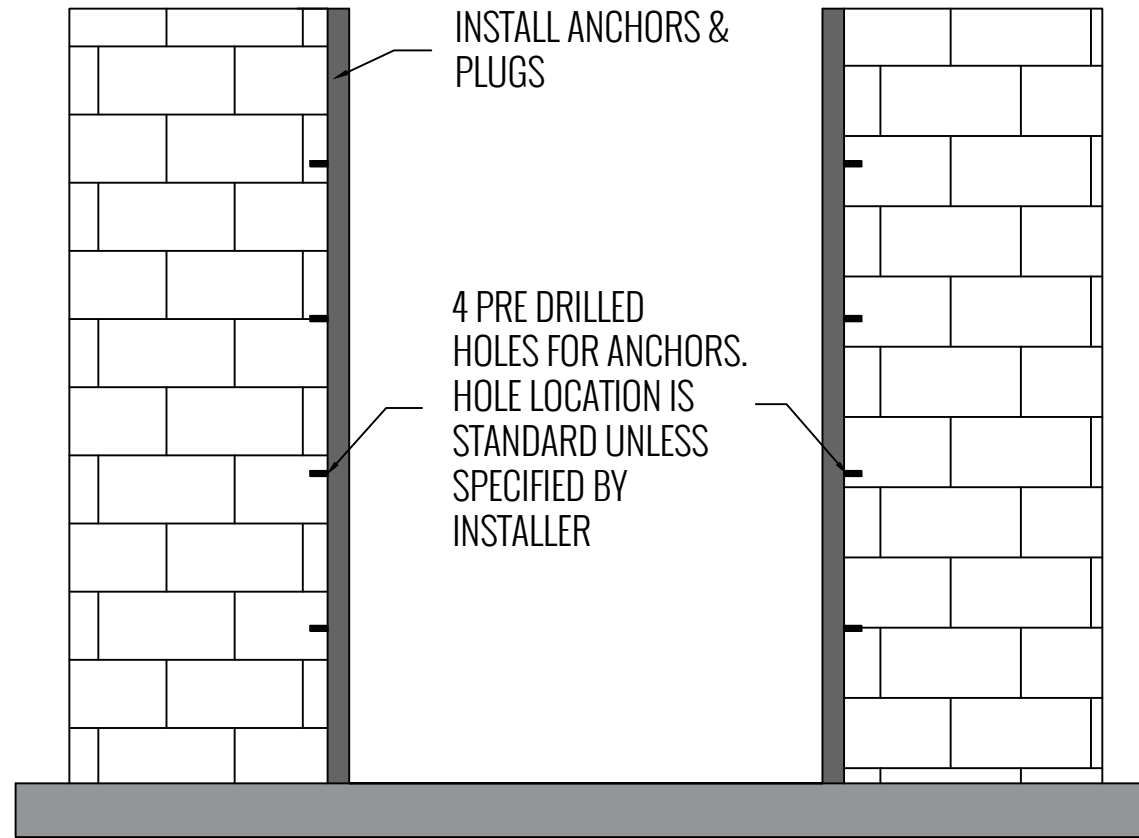

HINGES COME PRE-MOUNTED

STANDARD HINGE TYPE:  
4"X4" HEAVY DUTY BALL BEARING BUTT HINGES

OTHER STYLES AVAILABLE  
(SELF CLOSING HINGES)

GATE & JAMBS ARE MORTISED FOR THE HINGE

SCREW HOLES ARE MACHINE THREADED INTO THE GATE & JAMB. SCREWS ARE 12/24X1" STAINLESS STEEL (SCREWS INCLUDED)

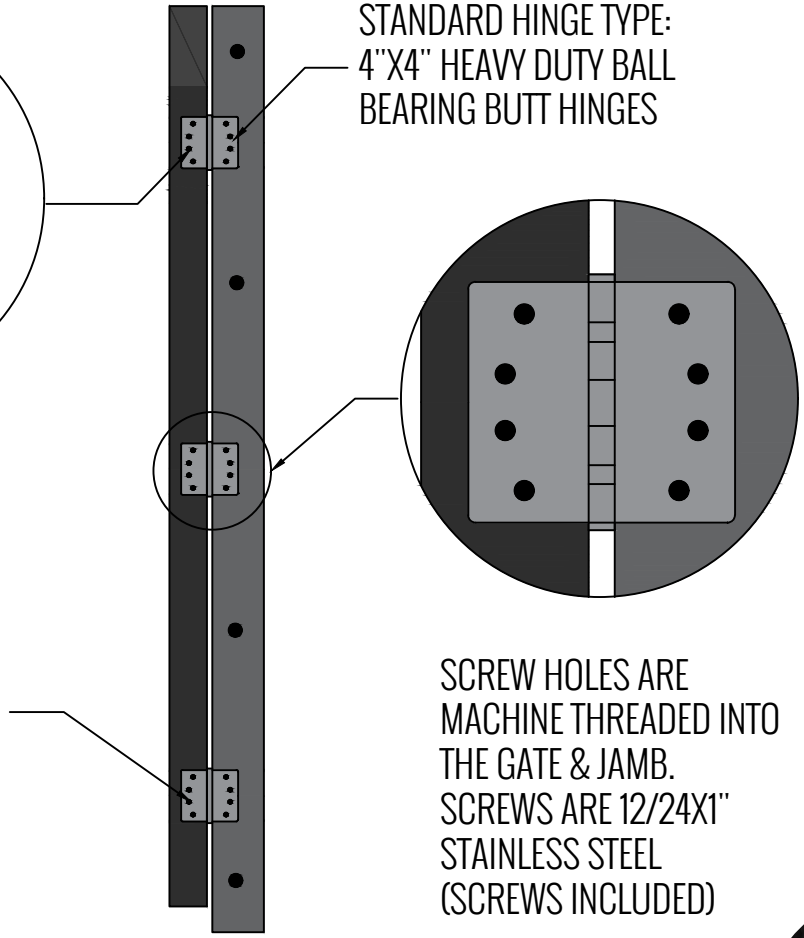

# STANDARD DIMENSIONS

PG 4

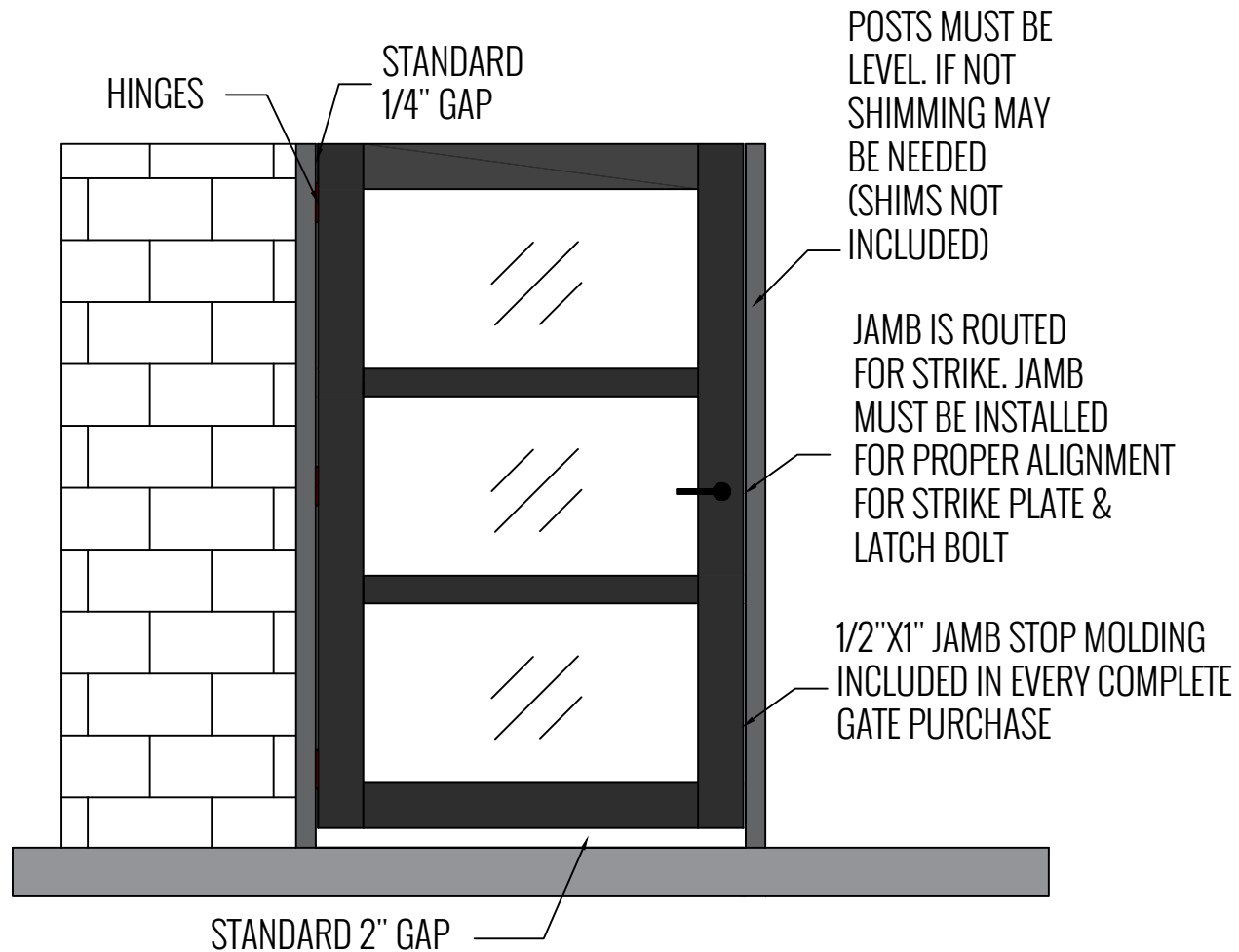

# POST INSTALLATION OPTIONS

PG 5

